

KARDANI jeftinija varijanta

Skraćeni cenovnik, ostale pozicije na upit

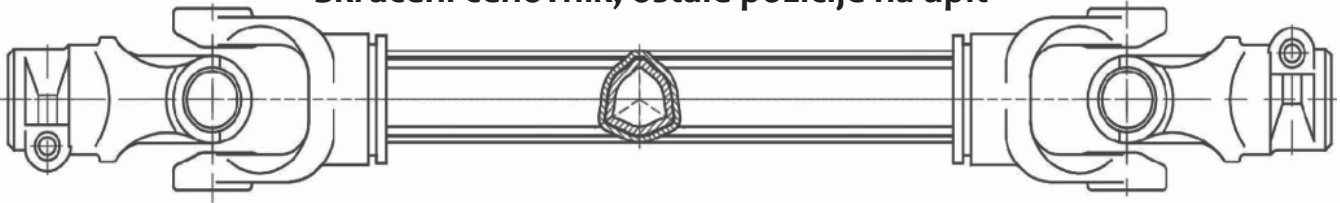

| naziv | €/kom |
|---|--------|
| T01-800-10501B-10501B - univerzalni kardan, trouglaste cevi, krstak Ø22x54, Lmin=800 (bez obloge) | 33.17 |
| T01-800-10501B-10501B(O) - univerzalni kardan, trouglaste cevi, krstak Ø22x54, Lmin=800 (sa oblogom) | 40.17 |
| T01-800-10501B-10503C30 (O) - kardan, trouglaste cevi, krstak Ø22x54, Lmin=800 (otvor Ø30 sa zlebom za klin i sa oblogom) | 43.75 |
| T01-1100-10501B-10501B (O) - univerzalni kardan, trouglaste cevi, krstak Ø22x54, Lmin=1100 (sa oblogom) | 45.17 |
| T01-1180-10507B-10503C30 - kardan, trouglaste cevi, krstak Ø22x54, Lmin=1180 (za prikolicu 509) | 74.75 |
| T01-800-10503C30-105FL57 - kardan, trouglaste cevi, krstak Ø22x54, Lmin=800 (za prikolicu 509, 408) | 69.00 |
| T01-2200-10507B30-105FL57 - kardan, trouglaste cevi, krstak Ø22x54, Lmin=2200 (za prikolicu LABIN) | 87.83 |
| T01-1180-10503C30-105FL57 - kardan, trouglaste cevi, krstak Ø22x54, Lmin=1180 (za prikolicu LABIN) | 74.75 |
| T01-1180-10507B30-10503C30 - kardan, trouglaste cevi, krstak Ø22x54, Lmin=1180 (za prikolicu LABIN) | 74.75 |
| T01-1180-10507B25-10503C30 - kardan, trouglaste cevi, krstak Ø22x54, Lmin=1180 (za prikolicu 408) | 74.75 |
| L01-1000-10501B-10501B - univerzalni kardan, limun cevi, krstak Ø22x54, Lmin=1000 (bez obloge) | 34.83 |
| L01-1000-10501B-10501B(O) - univerzalni kardan, limun cevi, krstak Ø22x54, Lmin=1000 (sa oblogom) | 41.25 |
| T02-800-20501B-20501B - univerzalni kardan, trouglaste cevi, krstak Ø23,8x61,3, Lmin=800 (bez obloge) | 35.67 |
| T02-800-20501B-20501B(O) - univerzalni kardan, trouglaste cevi, krstak Ø23,8x61,3, Lmin=800 (sa oblogom) | 39.08 |
| T04-700-40501B-40501B (O) - univerzalni kardan, trouglaste cevi, krstak Ø27x74,6, Lmin=700 (sa oblogom) | 59.92 |
| T04-900-40501B-40501B - univerzalni kardan, trouglaste cevi, krstak Ø27x74,6, Lmin=900 (bez obloge) | 56.83 |
| T04-900-40501B-40501B(O) - univerzalni kardan, trouglaste cevi, krstak Ø27x74,6, Lmin=900 (sa oblogom) | 61.75 |
| T04-900-40501B-4SB(SV) - kardan lamela sa smicucim vijkom, trouglaste cevi, krstak Ø27x74,6, Lmin=900 (bez obloge) | 81.50 |
| T04-900-40501B-4SB(O+SV) - kardan lamela sa smicucim vijkom, trouglaste cevi, krstak Ø27x74,6, Lmin=900 (sa oblogom) | 86.00 |
| T04-900-40501B-4RA1(O+L) - kardan lamela jednosmerna, trouglaste cevi, krstak Ø27x74,6, Lmin=900 (sa oblogom) | 90.25 |
| T04-900-40501B-4SA2 (O+L) - kardan, lamela jednosmerna, trouglaste cevi, krstak Ø27x74,6, Lmin=900 (sa oblogom) | 90.25 |
| T04-900-40501B-4FF1(O+L) - kardan lamela frikciona, trouglaste cevi, krstak Ø27x74,6, Lmin=900 (sa oblogom) | 117.50 |
| T04-1000-40501B-40501B (O) - univerzalni kardan, trouglaste cevi, krstak Ø27x74,6, Lmin=1000 (sa oblogom) | 63.33 |
| T04-1100-40501B-40501B - univerzalni kardan, trouglaste cevi, krstak Ø27x74,6, Lmin=1100 (bez obloge) | 56.83 |
| T04-1200-40501B-40501 (O) - univerzalni kardan, trouglaste cevi, krstak Ø27x74,6, Lmin=1200 (sa oblogom) | 81.25 |
| T04-1250-40501B-4RA1 (O+L) - kardan, lamela jednosmerna, trouglaste cevi, krstak Ø27x74,6, Lmin=1250 (sa oblogom) | 97.08 |
| T04-1250-40501B-4SA2 (O+L) - kardan, lamela sigurnosna, trouglaste cevi, krstak Ø27x74,6, Lmin=1250 (sa oblogom) | 97.08 |
| T04-1250-40501B-4SA3 (O+L) - kardan, lamela frikciona, trouglaste cevi, krstak Ø27x74,6, Lmin=1250 (sa oblogom) | 106.08 |
| T04-1300-40501B-40501B - univerzalni kardan, trouglaste cevi, krstak Ø27x74,6, Lmin=1300 (bez obloge) | 75.29 |
| T04-1300-40501B-40501B(O) - univerzalni kardan, trouglaste cevi, krstak Ø27x74,6, Lmin=1300 (sa oblogom) | 81.84 |
| T04-1300-40501B-4FF1 (O+L) - kardan, lamela frikciona, trouglaste cevi, krstak Ø27x74,6, Lmin=1300 (sa oblogom) | 117.50 |
| T04-1800-40501B-40501B - univerzalni kardan, trouglaste cevi, krstak Ø27x74,6, Lmin=1800 (bez obloge) | 90.17 |
| T06-700-60501B-60501B (O) - univerzalni kardan, trouglaste cevi, krstak Ø30.2x92, Lmin=700 (sa oblogom) | 87.50 |
| T06-900-60501B-60501B - univerzalni kardan, trouglaste cevi, krstak Ø30.2x92, Lmin=900 (bez obloge) | 78.75 |
| T06-900-60501B-60501B (O) - univerzalni kardan, trouglaste cevi, krstak Ø30.2x92, Lmin=900 (sa oblogom) | 87.50 |
| T06-900-60501B-6SB (O+SV) - kardan, lamela sa smicucim vijkom, trouglaste cevi, krstak Ø30,2x92, Lmin=900 (sa oblogom) | 104.83 |
| T06-900-60501B-6FF2(O+L) - kardan lamela frikciona, trouglaste cevi, krstak Ø30,2x92, Lmin=900 (sa oblogom) | 122.50 |
| T06-1200-60501B-60501B (O) - univerzalni kardan, trouglaste cevi, krstak Ø30.2x92, Lmin=1200 (sa oblogom) | 92.50 |
| T06-1200-60501B-6FF2 (O+L) - kardan, lamela frikciona, trouglaste cevi, krstak Ø30.2x92, Lmin=1200 (sa oblogom) | 127.08 |
| T06-1300-60501B-60501B - univerzalni kardan, trouglaste cevi, krstak Ø30,2x92, Lmin=1300 (bez obloge) | 84.17 |
| T06-1300-60501B-60501B(O) - univerzalni kardan, trouglaste cevi, krstak Ø30,2x92, Lmin=1300 (sa oblogom) | 93.75 |
| T06-1300-60501B-6RA2(O+L) - kardan, lamela jednosmerna, trouglaste cevi, krstak Ø30,2x92, Lmin=1300 (sa oblogom) | 110.00 |
| T06-1300-60501B-6FF2(O+L) - kardan lamela frikciona, trouglaste cevi, krstak Ø30,2x92, Lmin=1300 (sa oblogom) | 131.25 |
| T06-1650-60501B-6FF2(O+L) - kardan lamela frikciona, trouglaste cevi, krstak Ø30,2x92, Lmin=1650 (sa oblogom) | 136.25 |
| T08-1500-80505B-80505B(O) - univerzalni kardan, trouglaste cevi, krstak Ø35x106,5, Lmin=1500 (sa oblogom) | 123.33 |
| T08-1800-80505B-80505B(O) - univerzalni kardan, trouglaste cevi, krstak Ø35x106,5, Lmin=1800 (sa oblogom) | 131.67 |

*****PROGRAM FKL** cene na upit
cene su bez PDV-a

Cene su podložne promenama - postoji mogućnost odobravanja rabata
+381 18 226 364, 018 222 927, 064 89 00 735

www.ami.rs

KARDANSKI PROGRAM JEFTINIJA VARIJANTA

KARDANSKI ZGLOBOVI

| Naziv | €/kom |
|---|--------|
| 1.06T-Ø22X54-10501B ; kardanski zglob, trouglasta cev šira (32,4) | 14.08 |
| 1.07T-Ø22X54-10501B ; kardanski zglob, trouglasta cev uža (26,6) | 14.08 |
| 2.06T-Ø23,8X61,3-20501B ; kardanski zglob, trouglasta cev šira (36,1) | 16.25 |
| 2.07T-Ø23,8X61,3-20501B ; kardanski zglob, trouglasta cev uža (29) | 16.25 |
| 4.06T-Ø27X74,6-40501B ; kardanski zglob, trouglasta cev šira (43,4) | 18.33 |
| 4.07T-Ø27X74,6-40501B ; kardanski zglob, trouglasta cev uža (36,1) | 18.33 |
| 6.06T-Ø30,2X92-60501B ; kardanski zglob, trouglasta cev šira (53,6) | 25.83 |
| 6.07T-Ø30,2X92-60501B ; kardanski zglob, trouglasta cev uža (44,7) | 25.83 |
| 4WA.07T - 4WA.05.07B ; širokougaoi (dupli) zglob, trouglasta cev uža (27) | 111.66 |
| 6WA.07T - 6WA.05.07B ; širokougaoi (dupli) zglob, trouglasta cev uža (30,2) | 128.66 |
| 1.06L-Ø22X54-10501B ; kardanski zglob, limun cev sira (30x39,1) | 14.08 |
| 1.07L-Ø22X54-10501B ; kardanski zglob, limun cev uza (23,7x30,8) | 14.08 |
| 2.06L-Ø23,8X61,3-20501B ; kardanski zglob, limun cev sira (41,2x48) | 16.25 |
| 2.07L-Ø23,8X61,3-20501B ; kardanski zglob, limun cev uza (34,5x40,1) | 16.25 |
| 4.06L-Ø27X74,6-40501B ; kardanski zglob, limun cev sira (41,2x48) | 18.33 |
| 4.07L-Ø27X74,6-40501B ; kardanski zglob, limun cev uza (34,5x40,1) | 18.33 |
| 6.06L-Ø30,2X92-60501B ; kardanski zglob, limun cev sira (48x57,5) | 25.83 |
| 6.07L-Ø30,2X92-60501B ; kardanski zglob, limun cev uza (39,5x49) | 25.83 |
| 4W.07L - 4WA.05.07B ; širokougaoi (dupli) zglob, limun cev manja (27x74,6) | 111.66 |
| 6WA.07L - 6WA.05.07B ; širokougaoi (dupli) zglob, limun cev manja (30,2x92) | 128.66 |
| 1.06R-Ø22X54-10501B ; kardanski zglob, pravougaona cev (32x34) - Univerzalni | 20.17 |
| 1.06R-Ø22X54-10501B-30 ; kardanski zglob, pravougaona cev (32x34) - Labin | 22.10 |
| 1.06R-Ø22X54-10503C30 ; kardanski zglob, pravougaona cev (32x34) - IMT 509 | 22.10 |
| 1.06R-Ø22X54-10507B-25 ; kardanski zglob, pravougaona cev (32x34) IMT 408 | 22.10 |
| 1.07R-Ø22X54-10501B ; kardanski zglob, pravougaona cev (23x25) - Univerzalni | 20.17 |
| 1.07R-Ø22X54-10503C30 ; kardanski zglob, pravougaona cev (23x25) - IMT 509 | 22.10 |
| 1.07R-Ø22X54-105FL57 ; kardanski zglob, pravougaona cev (23x25) - Labin i 509 | 25.83 |

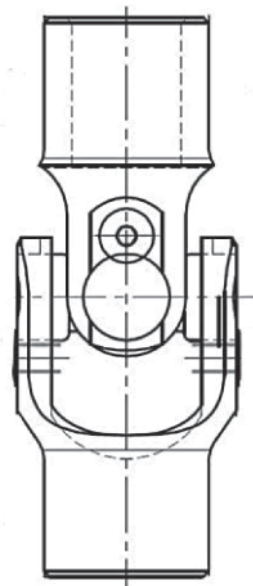

KARDANSKE CEVI

| Trougao | 1000mm | | 3000mm | |
|-------------------------------------|--------|-------|--------|--------|
| | €/kom | €/m | €/kom | €/m |
| 26,6x3,5 (unutarnja T01) | 6.50 | 6.83 | | |
| 29x4 (unutarnja T02) | 7.00 | 7.33 | | |
| 32,4x2,5 (spoljna T01) | 6.75 | 7.08 | | |
| 36,1x3,4 (spoljna T02) | 9.42 | 9.83 | | |
| 36,1x4,4 (unutarnja T04) | 12.17 | 12.67 | | |
| 43,4x3,3 (spoljna T04) | 10.67 | 11.08 | | |
| 44,7x4 (unutarnja T05 i T06) | 14.08 | 14.50 | | |
| 44,7x5,5 (unutarnja T07) | 18.33 | 18.83 | | |
| 51,3x3 (spoljna T05) | 11.75 | 12.17 | | |
| 53,6x3,8 (spoljna T06 i T07) | 16.58 | 17.25 | | |
| 53,6x4,2 (spoljna T06 i T07) | 16.58 | 17.25 | | |
| 53,6x5 (unutarnja T08) | 21.83 | 22.58 | | |
| 62,7x4 (spoljna T08) | 22.92 | 23.58 | | |
| | | | 1000mm | 3000mm |
| | | | €/kom | €/m |
| Limun | | | | |
| 30,8x23,7x3,5 (unutarnja L01) | 6.50 | 6.83 | | |
| 39x30x3 (spoljna L01) | 7.00 | 7.33 | | |
| 40,1x34,5x4 (unutarnja L02 i L04) | 10.33 | 10.67 | | |
| 48x41,27x3 (spoljna L02 i L04) | 11.00 | 11.58 | | |
| 49,2x39,6x4,5 (unutarnja L05 i L06) | 15.08 | 15.67 | | |
| 57,6x48,2x3,5 (spoljna L05 i L06) | 17.08 | 17.58 | | |



KARDANSKE VILE

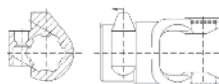

| Naziv | €/kom |
|---|-------|
| 1.05.07B-30 ; krst Ø22x54, 6 žlebova Ø30, priključna vila za LABIN | 10.25 |
| 1.05.07B-25 ; krst Ø22x54, 6 žlebova Ø25, priključna vila za 408 | 10.25 |
| 1.05.03C030 ; krst Ø22x54, žleb za klin, priključna vila za 509, LABIN | 10.25 |
| 1.05.FL57 ; krst Ø22x54, priburica Ø87,5 sa 4 rupe, priključna vila za 509, LABIN | 15.50 |
| 1.05.01B ; krst Ø22x54, 6 žlebova Ø35 | 7.42 |
| 2.05.01B ; krst Ø23,8x61,3, 6 žlebova | 8.25 |
| 4.05.01B ; krst Ø27x74,6, 6 žlebova | 8.58 |
| 6.05.01B ; krst Ø30,2x92, 6 žlebova | 10.00 |
| 7.05.05B ; krst Ø30,2x106,5, 6 žlebova | 23.25 |
| 32.05.01B ; krst Ø32x76, 6 žlebova | 14.58 |
| 8.05.05B ; krst Ø35x106,5, 6 žlebova | 24.75 |
| 1.06T (spoljna vila) ; krst Ø22x54, trouglasta cev sira (32,4) | 9.33 |
| 1.07T (unutarnja vila) ; krst Ø22x54, trouglasta cev uža (26,6) | 9.33 |
| 1.06R (32x34) ; krst Ø22x54, pravougaona cev sira (32x34) | 9.88 |
| 1.07R (23x25) ; krst Ø22x54, pravougaona cev uža (23x25) | 9.88 |

***PROGRAM **FKL** CENE NA UPIT

KARDANSKE SPOJNICE (LAMELE)

| Naziv | €/kom |
|--|-------|
| Kardan. spojnica 4FF1 (1000Nm, 1 3/8 Z6) KKØ27 | 45.92 |
| Kardan. spojnica 4RA1 (2400Nm, 1 3/8 Z6) KKØ27 | 26.42 |
| Kardan. spojnica 4SA2 (800Nm, 1 3/8 Z6) KKØ27 | 48.83 |
| Kardan. spojnica 4SB (1480Nm, 1 3/8 Z6) KKØ27 | 15.83 |
| Kardan. spojnica 6FF2 (1800Nm, 1 3/8 Z6) KKØ30.2 | 56.25 |
| Kardan. spojnica 6SA2 (3500Nm, 1 3/8 Z6) KKØ30.2 | 34.00 |



SA/RA



SB



FF

cene su bez PDV-a

Cene su podložne promenama - postoji mogućnost odobravanja rabata
+381 18 226 364, 018 222 927, 064 89 00 735

www.ami.rs